



JESUP MEMORIAL LIBRARY

Bar Harbor, ME

This historic 12,800 SF library, listed on the National Register of Historic Places, is undergoing a renovation with a 9,600 SF modern addition. The project will provide much-needed program space while honoring the library's original design, including expanded areas for children's programming, adult reading, meeting rooms, community spaces, and archival storage.

This innovative project sets new standards in sustainability by utilizing Eastern Hemlock and SPF-S lumber for CLT floors, roofs, and shaft walls, all locally sourced from New England. This project is proudly supported by wood utilization work and expertise from University of New Hampshire Extension and Innovative Natural Resources Solutions. The glulam components, provided by our partners QB Corp out of Salmon, Idaho feature doug-fir glulam, showcasing the versatility and beauty of timber in modern construction.



PROJECT ISOMETRIC

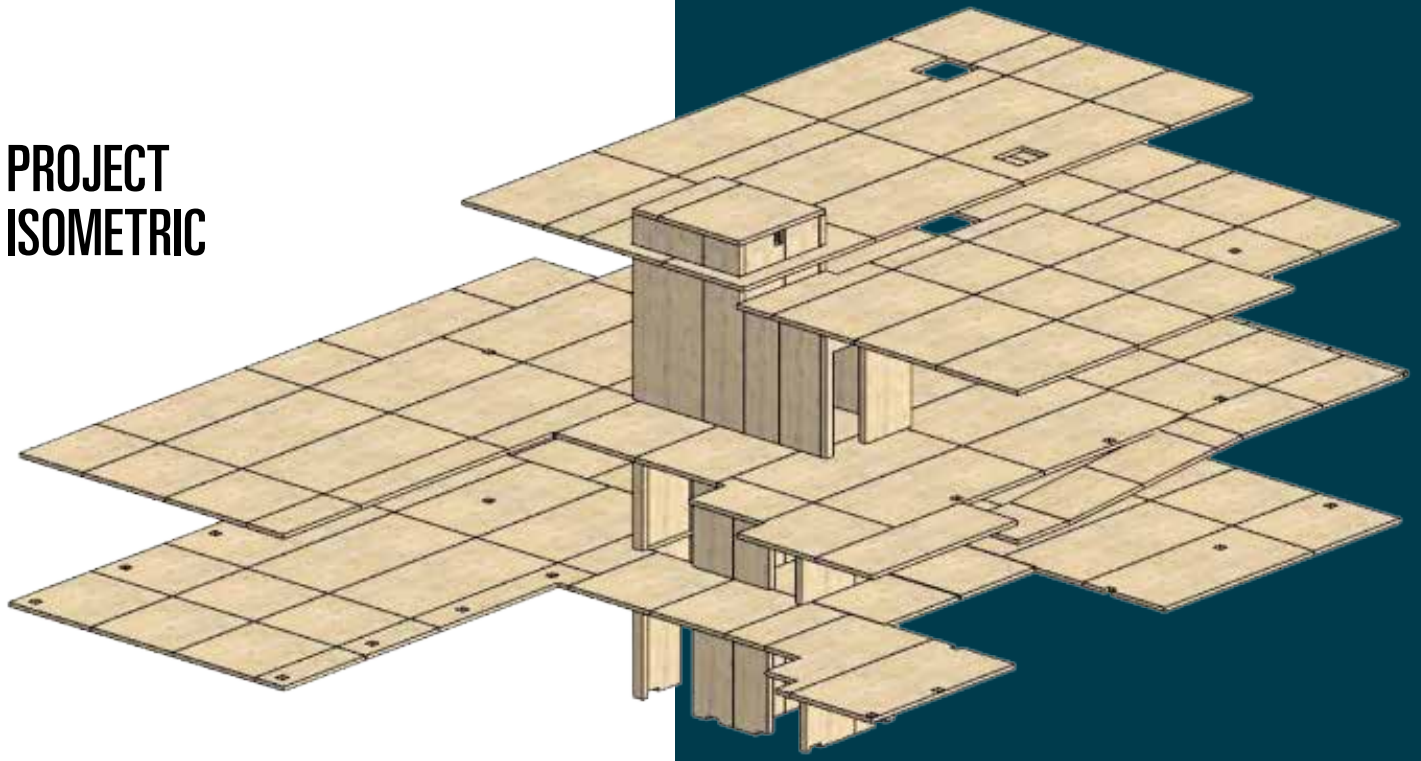

PROJECT DETAILS

YEAR BUILT: 2024

OF STORIES: 3

SQ FT: 9,601

BLDG SYSTEMS: IV

BUILDING TYPE: Public Library

MATERIAL TYPES: Cross-Laminated Timber
Glue-Laminated Timber

PROJECT TEAM: Glulam Partner – QB CORP
Connection Hardware Partner – Simpson Strong-tie
Contractor – E.L. Shea
Engineer – Thornton Tomasetti
Architect – Simons Architects

By balancing preservation and innovation, this renovation will ensure the library continues to serve Bar Harbor and its surrounding communities for generations to come.

