



TERRALAM® CLT



MASS TIMBER FOR THE MASSES



SUSTAINABILITY MEETS AFFORDABILITY

Since roughly 75% of the carbon sequestered in a mass timber building is stored in its floor and roof slabs, increasing the adoption of mass timber for horizontal plate applications can significantly reduce the carbon footprint of your buildings. This approach provides flexibility for the utilization of a wider range of vertical support materials while making substantial progress in sustainability.

WHY MASS TIMBER?



FASTER
CONSTRUCTION



LOWER EMBODIED
CARBON



ARCHITECTURALLY
ELEGANT

WHY CHOOSE STERLING?



SCALABLE,
MODULAR DESIGN



ACCESSIBLE
PRICE POINT



HIGH VOLUME
PRODUCTION

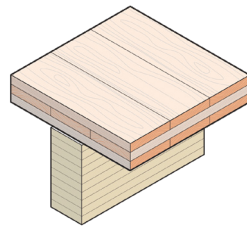
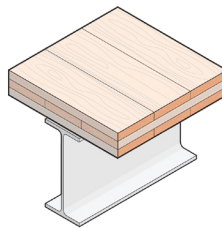



Let's Talk Timber

708.940.4403



Proudly grown, sourced & manufactured in the US

